

SOUTHWORTH

Owner's Manual **PalletPal™ 360** Level Loader



Model # _____

Serial # _____

Placed in Service _____

Southworth Products Corp

P.O. Box 1380, Portland, Maine 04104-1380

Phone 800/743-1000 or 207/878-0700 Fax 207/797-4734

www.SouthworthProducts.com

Service@SouthworthProducts.com

NOVEMBER 2016

This manual covers all types of PalletPal™ 360 models including standard finish steel and special finishes like epoxy or hot dipped galvanized.



The PalletPal 360° was introduced in June 2011, and if your unit looks like this you have the correct PalletPal 360° owner's manual.



If your unit looks like this DO NOT use this manual. Go to www.SouthworthProducts.com and download the owner's manual for the original PalletPal titled 'PalletPal (Spring) Manual'.

Please note: This manual was current at the time of printing. To obtain the latest, most updated version, please contact Southworth's Customer Service Department or go to our website: www.SouthworthProducts.com, under the Parts & Service tab you will find a complete list of current owner's manuals to print.

Contents

INTRODUCTION	Page 4
RESPONSIBILITY OF OWNERS AND USERS	5
SAFETY	6
Safety Alert Symbols and Signal Words	7
Installation Notes	8
Operation Notes – Manual Use	8
Operation Notes – Use with Fork Lift or Stacker	9
SPECIFICATIONS	9
INSTALLATION INSTRUCTIONS	10
Unpacking the Unit	10
Spring Selection Charts	10
Installing the Optional Adjustable Feet	11
Installing the Springs	11-16
OPERATING INSTRUCTIONS	17
Loading Manually	17
Removing Loads Manually	17
Operating Safety – Manual use	17
Loading with a Fork Lift	17
Unloading with a Fork Lift	18
Moving the PalletPal.....	18
MAINTENANCE	18
Routine Periodic Maintenance.....	18
TROUBLESHOOTING	19
ORDERING REPLACEMENT PARTS	20
WARRANTY	21

List of Figures

Fig. 1	Safety Labels	8
Fig. 2	Pinch Points	8
Fig. 3	Orange Spring Installed	11
Fig. 4-17	Step by Step Installation	12 - 16
Fig. 18	Spring Mounting Positions	16
Fig. 19	Loading Manually	17
Fig. 20	Unloading Manually	17
Fig. 21	Loading with a Fork Lift	18
Fig. 22	Unloading with a Fork Lift	18
Fig. 23	Moving the PalletPal	18

Introduction

The PalletPal™ Level Loader is a simple device which will automatically maintain a load at the ideal height for manual loading and unloading. If a palletized load is placed on the unit, the unit gradually rises as boxes or parts are removed. This automatically maintains the top of the load at the correct working height.

The unit may also be used in another way. An empty pallet may be placed on the PalletPal. The unit gradually lowers as boxes or parts are added. Again, this keeps the top of the load at the correct height. Complete pallets may be loaded or unloaded using a fork lift.

Each PalletPal™ unit includes a steel scissor lift mechanism and at least one large compression spring. The calibrated springs are chosen to match the weight and height of a fully loaded pallet. Springs are available for a wide range of weight and height combinations. The PalletPal™ also includes a shock absorber. This eliminates any tendency for the load to bounce on the springs.

This manual contains information to help you to learn about the safe and proper installation, use, and upkeep of your PalletPal™ unit. Please be sure that this manual is available to anyone who uses or services the PalletPal™ unit.

PalletPal units may be used in a wide variety of industrial settings. The instructions in this manual are not necessarily all-inclusive, as Southworth cannot anticipate all conceivable or unique situations. **In the interest of safety, please read this whole manual carefully. Be familiar with the contents of this manual before you install or use the PalletPal unit. If you are not sure of the proper procedure to be followed, please call Southworth Products Corporation for more information.**

Southworth's product warranty is shown on the rear cover of this manual. **This instruction manual is not intended to be or to create any other warranty, express or implied, including any implied warranty of merchantability or fitness for a particular purpose, all of which are hereby expressly excluded.** As set forth more specifically in the product warranty, Southworth's obligation under that warranty is **limited** to the repair or replacement of defective components, which shall be the buyer's **sole remedy**, and Southworth shall not be liable for any loss, injury, or damage to persons or property, nor for any direct, indirect, or consequential damage of any kind resulting from the PalletPal unit.

Responsibility of Owners and Users

Inspection and Maintenance

The device shall be inspected and maintained in proper working order in accordance with Southworth's owner's manual.

Removal from Service

Any device not in safe operating condition such as, but not limited to, missing rollers, pins, or fasteners, any bent or cracked structural members, damaged or malfunctioning springs, etc. shall be removed from service until it is repaired to the original manufacturer's standards.

Deflection

It is the responsibility of the user/purchaser to advise the manufacturer where deflection may be critical to the application.

Repairs

All repairs shall be made by qualified personnel in conformance with Southworth's instructions.

Operators

Only trained personnel and authorized personnel shall be permitted to operate the positioner.

Before Operation

Before using the device, the operator shall have:

- Read and/or had explained, and understood, the manufacturer's operating instructions and safety rules.
- Inspected the device for proper operation and condition. Any suspect item shall be carefully examined and a determination made by a qualified person as to whether it constitutes a hazard. All items not in conformance with Southworth's specification shall be corrected before further use of the equipment.

During Operation

The device shall only be used in accordance with this owner's manual.

- Do not overload.
- Ensure that all safety devices are operational and in place.

Modifications or Alterations

Modifications or alterations to any Southworth industrial positioning equipment shall be made only with written permission from Southworth.

Safety

The PalletPal™ unit has been carefully designed to be as safe as possible for operators and service workers. If you take a few common-sense precautions, you will be able to use the unit safely. However, the PalletPal™ is a powerful unit with moving parts, and is capable of causing personal injury if proper precautions are not taken.

Therefore, throughout this manual, Southworth has identified certain hazards which may occur in the use and servicing of the PalletPal™ unit, and provided appropriate instructions or precautions which should be taken to avoid these hazards. In some cases, Southworth has also pointed out the consequences which may occur if Southworth's instructions or precautions are not followed. Southworth uses the following system of identifying the severity of the hazards associated with its products:



Immediate hazard which will result in severe personal injury or death.



Hazard or unsafe practice which could result in severe personal injury or death.



Hazard or unsafe practice which could result in minor personal injury or property damage.

Please read and follow this instruction manual, including all safety instructions and precautions, carefully and completely.

Figure 1 shows the safety labels on this unit. Please be sure that all of the labels are in place, and are visible to the machine operators. Never paint over the labels. If any of the labels are missing, please contact Southworth for replacements. **The safety labels help to protect your workers.**

SAFETY ALERT SYMBOLS AND SIGNAL WORDS

The safety of all persons operating, maintaining, repairing, or in the vicinity of this equipment is of paramount concern. This is a powerful machine with moving parts, and is capable of causing personal injury if proper precautions are not taken. Therefore, throughout this manual, certain hazards have been identified which may occur in the use of the machine, and there are appropriate instructions or precautions which should be taken to avoid these hazards. In some cases, there are consequences which may occur if instructions or precautions are not followed. Below are the symbols and signal words along with their definitions referenced from ANSI Z535.4 - Product Safety Signs and Labels.

Safety Alert Symbols

These are the safety alert symbols. They are used to alert you to potential physical injury hazards. Obey all safety messages that follow this symbol to avoid possible injury or death.



For use with DANGER signal word
(Red Background)



For use with WARNING signal word
(Orange Background)



For use with CAUTION signal word
(Yellow Background)

Signal Words

The meaning of different signal words as defined by ANSI Standard Z535.4 indicates the relative seriousness of the hazardous situation.



(Danger = Red Background)

DANGER indicates a hazardous situation which, if not avoided, will result in death or serious injury.



(Warning = Orange Background)

WARNING indicates a hazardous situation which, if not avoided, could result in death or serious injury.



(Caution = Yellow Background)

CAUTION, used with the safety alert symbol, indicates a hazardous situation which, if not avoided, could result in minor or moderate injury.



(Notice = Blue Background)

NOTICE is used to address practices not related to personal injury.



(Safety Instructions = Green Background)

SAFETY INSTRUCTIONS (or equivalent) signs indicate safety-related instructions or procedures.

Fig. 1. Safety Labels

PalletPal 360

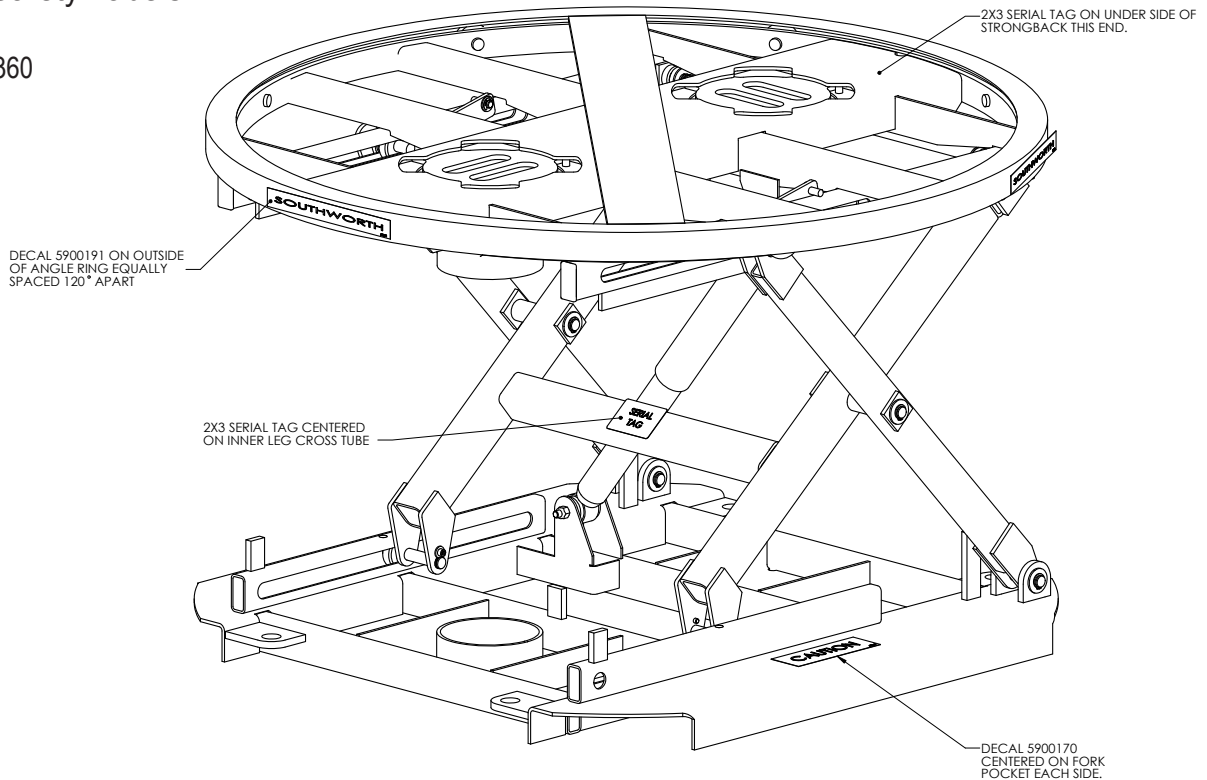

Installation Notes

NOTICE

The unit must be installed on a firm, nearly-level surface. The frame of the unit must sit firmly on the floor, and the floor must be level. If the frame is not supported correctly, stresses may develop in the frame. The unit may bind or not work easily. The rotating ring may not rotate correctly.

WARNING

After the springs are installed, if the springs are not seated correctly, or the twist-lock caps are not tightened, the parts may loosen when the unit is used. You may be hurt, or the load may be damaged.

Operation Notes – Manual Use

WARNING

Never operate the unit if anyone is sitting or riding on the rotating ring.

WARNING

Never operate the unit if the load is off-center. The load may shift, and you may be injured. This can also damage the unit.

WARNING

As the unit moves, keep away from the “pinch points” where metal parts meet. See Fig. 2.

WARNING

Keep the area around the unit clean. Do not allow any dirt, debris, spilled oil, or excess grease to collect. These materials may cause you to slip while the unit is operating, and you may be injured.

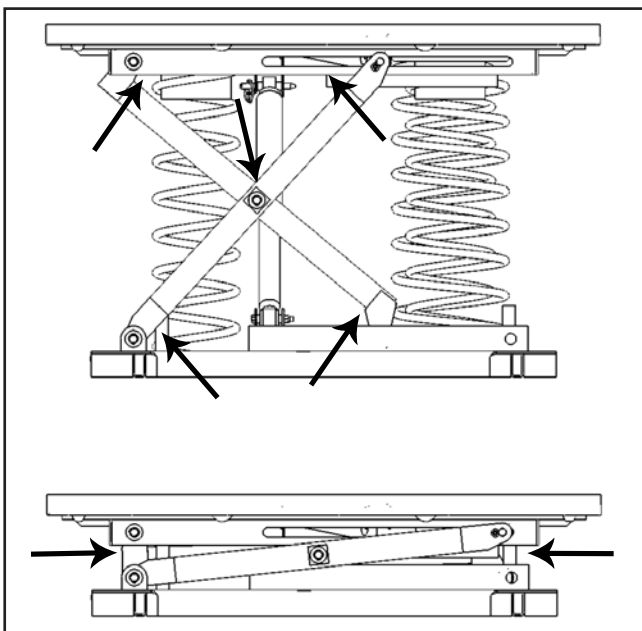

Fig. 2. Pinch Points

⚠ WARNING

Stay clear of the rotating ring when it is moving. As the pallet turns, a part of the load may rotate around and hit you. Never turn the load when anyone is standing beside the unit.

⚠ WARNING

Do not try to use this unit with damaged or broken pallets. Broken pallets may have boards or nails which hang down below the main part of the pallet. As the pallet is turned, these boards or nails may catch on the frame of the unit. This can cause the pallet to stop turning suddenly, causing the load to shift.

You may be injured, and the unit may be damaged. The boards or nails on the bottom of the pallet should not extend down more than 1/8 inch.

completely before removing the fork lift. The pallet must be completely supported by the PalletPal. If you do not do this, the load may be dropped when you remove the fork lift. The unit or the load may be damaged, or you may be hurt. Figure 21 shows the correct way to load using a fork lift.

When unloading using a fork lift or stacker –

⚠ WARNING

When removing a load from the unit, lift the load clear of the PalletPal before backing out the fork lift. If you do not do this, the top of the unit may jump up when you remove the fork lift. The unit or the load may be damaged, or you may be hurt. Figure 22 shows the correct way to unload using a fork lift.

When moving the PalletPal -

NOTICE

Do not move the PalletPal while it is loaded. This will damage the base frame of the unit. The pockets on the base frame are designed to support an unloaded PalletPal, they cannot support any extra weight.

Operation Notes:

Use with Fork Lift or Stacker

You must take some special precautions when using a fork lift or stacker with the unit:

When loading using a fork lift or stacker –

⚠ WARNING

When adding a load to the unit, lower the forks

Specifications

	Imperial	Metric
Load capacity	400 to 4500 lbs.	180kg to 2025kg
Load size	50" x 5" x 72" high	1270mm x 1270mm
Base Frame	36" x 36"	915mm x 915mm
Compressed height	9 1/2 inches	240mm
Extended height	27 3/4 inches	705mm
Rotating ring, outside diameter	43 5/8 inches	1,110mm
Rotating ring, inside diameter	40 5/8 inches	1,030mm
Net weight	380 lbs.	170kg

Installation Instructions

Unpacking the PalletPal 360

1. Before you start to install the unit, check for local codes and ordinances which may apply. It is your responsibility to obtain any necessary permits.
2. Please read all of these instructions carefully. Be sure to read and understand all of the warnings.

3. Inspect the shipping pallet carefully for any damage which may have affected the unit. If you see signs of damage, tell the trucker. Also make a note of this on the shipping papers which you are asked to sign.

4. Choose the place where you want to use the unit. It is very important that the PalletPal be set up on a smooth and flat surface. Check the floor surface carefully and make sure that it is free of all loose debris and dirt.

		Weight of Fully Loaded Pallet (lbs and kgs)											
		0-400lb	400-800lb	800-1200lb	1200-1600lb	1600-2000lb	2000-2400lb	2400-2800lb	2800-3200lb	3200-3600lb	3600-4000lb	4000-4500lb	
		0-180kg	180-360kg	360-540kg	540-720kg	720-900kg	900-1080kg	1080-1260kg	1260-1440kg	1440-1620kg	1620-1800kg	1800-2025kg	
Height of Fully Loaded Pallet (ins. and mm)	58-60"	1475-1525 mm	0	0	1	1	1	1	2	2	2	3	3
	56-58"	1420-1475 mm	0	0	1	1	1	2	2	2	2	3	3
	54-56"	1370-1420 mm	0	0	1	1	1	2	2	2	2	3	3
	52-54"	1320-1370 mm	0	1	1	1	1	2	2	2	3	3	3
	50-52"	1270-1320 mm	0	1	1	1	1	2	2	2	3	3	4
	48-50"	1220-1270 mm	0	1	1	1	1	2	2	2	3	3	4
	46-48"	1170-1220 mm	0	1	1	1	1	2	2	3	3	3	4
	44-46"	1120-1170 mm	0	1	1	1	2	2	3	3	3	4	4
	42-44"	1065-1120 mm	0	1	1	2	2	2	3	3	4	4	4
	40-42"	1015-1065 mm	0	1	1	2	2	3	3	3	4	4	4
	38-40"	965-1015 mm	0	1	1	2	2	3	3	4	4	4	4
	36-38"	915-965 mm	0	1	1	2	2	3	4	4	4	4	4
	34-36"	865-915 mm	1	1	2	2	3	3	4	4	4	4	-
	32-34"	815-865 mm	1	1	2	3	3	4	4	4	4	-	-
30-32"	760-815 mm	1	1	2	3	3	4	4	4	4	-	-	

- 0 Range 0 – White Spring Only (see below)
- 1 Range 1 – Orange Spring (1 Spring)
- 2 Range 2 – Orange and Gray Springs (2 Springs)
- 3 Range 3 – Orange and Purple Springs (2 Springs)
- 4 Range 4 – Orange, Gray, and Purple Springs (3 Springs)

PalletPal comes complete with rotator ring, fork truck pockets in base and selected range spring package.

1. Fill in the weight of a fully loaded pallet here: _____
(Do not guess. Get actual weight or have a pallet weighed)¹
2. Fill in the height of a fully loaded pallet here: _____
(Do not guess. Get actual height or measure a loaded pallet)¹
3. Using the chart, select the correct PalletPal range: _____



Note: PalletPal springs are precisely calibrated and will work best within the load weight and height ranges selected. Should pallet weight or height weight requirements dramatically change, PalletPal can be adapted in the field at any time by simply changing the spring combination used.

Range 0 uses a special white spring that is factory installed and the PalletPal is shipped raised.

Table 1 - Spring selection chart

Using optional adjustable feet, the unit can compensate for a slightly sloping floor (1:25), but the surface must be smooth and solid.

CAUTION

The unit must be installed on a smooth flat surface. If the floor is not flat, this can create stresses in the frame of the unit. The unit may not work properly, or parts of the unit may wear more quickly than they should. You may be hurt or the load may be damaged.

5. Position the PalletPal beside the point where the unit will be set up.
6. Remove the banding which secures the unit to the pallet. Remove all packing material. Shift the unit to the floor. Support the base as you do this.
7. Check to see that the frame of the unit is sitting firmly on the floor. Try to move or rock the frame of the unit. The base frame should be stable, and should not move. Check to see that the base frame is level. (If any part of the frame is more than $\frac{1}{2}$ " out of level in relation to any other part, you must install the optional adjustable feet to level the unit. See the instructions below.)

8. Remove the springs and lay them out on the floor.
9. If you have any questions about the steps in the installation process, please call Southworth Customer Service at 1-800-743-1000.

Setting up and Installing the Springs

1. The PalletPal will always have at least one spring. This spring has an orange mark, and is larger in diameter than the others. This large orange spring is always placed in the front of the unit. Figure 3 shows the position of the first spring.

The frame of the unit can handle loads of up to 4500 lbs. In order to adapt the unit for different pallet loads, the springs are changed. The springs are chosen to match the weight and height of a fully loaded pallet. A unit may have one to three springs.

Each time the pallet weight or pallet height is changed, the springs may also need to be changed. Table 1 on page 10 show how the springs are selected.

2. The unit is shipped without springs installed. The installation of the first spring (orange) requires two people. Lift off rotating ring and both yellow bayonets. Set them aside, they will be



Fig. 3 Orange Spring Installed

Optional Adjustable Feet

Adjust each of the feet until the base frame of the PalletPal unit is level. All four of the feet must touch the floor. Once the settings are correct, tighten the nuts against the mounting frame.

Fig. 4



installed later.

Fig. 5



3.

The shock absorber is attached to the top frame of the unit with a pivot pin, and this is held in place by a linch pin. The pivot pin is used to hold the table frame in the raised position. Take a look at the mechanism and note the positions of the parts. Remove the linch pin and remove the pivot pin. Lay the free end of the shock absorber down.

Fig. 6



4.

With the help of an assistant, lift the top frame until it hits the upper latch stops.

Fig. 7



5. While holding both latches up and lift the top frame pass the latches until it is at its full, upper most position. Have the assistant hold the weight and insert the pivot pin in the hole in the base frame. See Fig. 8. With the PalletPal in this full upper most position the orange spring can be installed.

Fig. 8



Fig. 9



Alignment
Tab



6. Insert either end of the large orange spring into the lower pocket on the front of unit. Be sure the bottom spring coil is positioned outside the alignment tab as shown.

Fig. 10



7.

Grasp the spring by the second or third coil down from the top (do **NOT** grasp the top coil or rung) and push the spring down and under the edge of the top frame.

Fig. 11



8.

While pushing down to compress spring push it forward into the pocket up under the top frame. It will "snap" into position when completely in the pocket.

Fig. 12



CORRECT

Fully inserted into pocket

Fig. 13



INCORRECT

Spring NOT fully inserted into pocket

Fig. 14

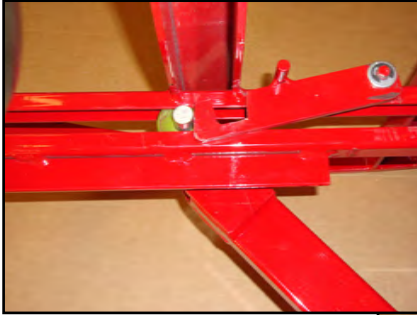

9.
Remove the shock absorber pivot pin. Push down on top frame until latches engage. (Both latches will drop into place).

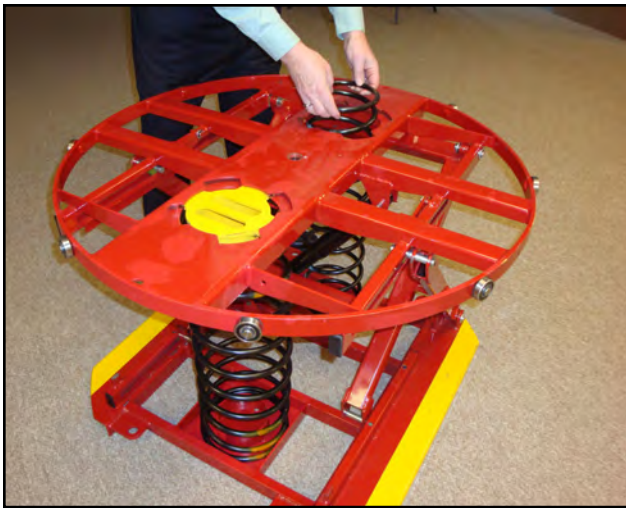

Fig. 15



10.
Reinstall the shock absorber pivot pin and linch pin.

Fig. 16



11.

Install additional springs as needed through the bayonet openings. See figure 18 and table 1 on page 10. Reinsert the yellow bayonets and twist to lock them in place.

Fig. 17



12.

Reinstall the rotator ring.

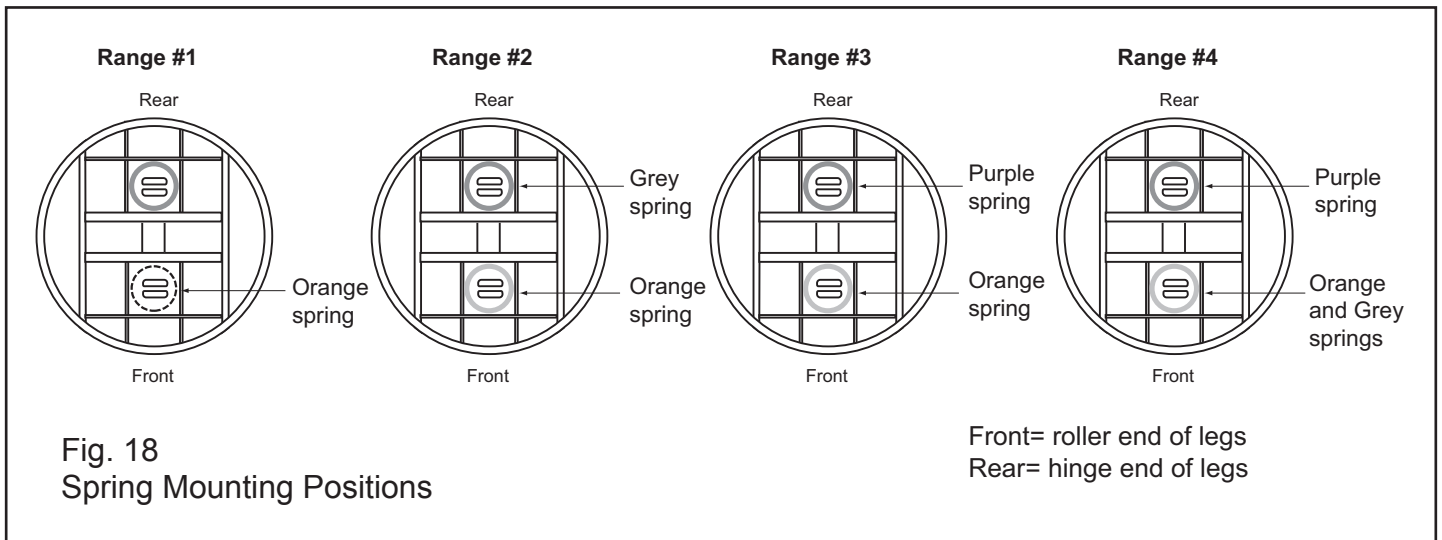

Fig. 18
Spring Mounting Positions

13.

Figure 18 shows the position of additional springs if needed. Double-check to be sure you have the correct springs. Refer to Table 1 on page 10 and see that you have the correct springs for your application.

Before using the unit, do a safety check. Be sure that each of the spring bayonet caps is in place and rotated to their locked position. Check the top and bottom of each spring to be sure it is seated correctly. Check the linch pin at the top of the shock absorber. These checks are very important.

The PalletPal 360 is now ready for use!

Operating Instructions

Loading Manually

Add boxes or parts until the pallet is full. Load the pallet in layers. Use the rotating ring to position the pallet to eliminate walking around. The unit will gradually lower the pallet until it reaches the bottom. See Fig. 19.



Rotate the pallet load. Never place your hands on the rotator ring. You may be hurt.

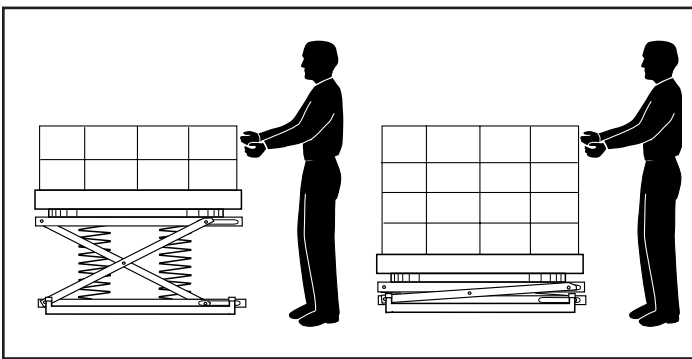

Fig. 19
Loading Manually

Removing Loads Manually

Remove boxes or parts until the pallet is empty. Unload the pallet in layers. Use the rotating ring to position the pallet to eliminate walking around. The unit will gradually raise the pallet. See Fig. 20.

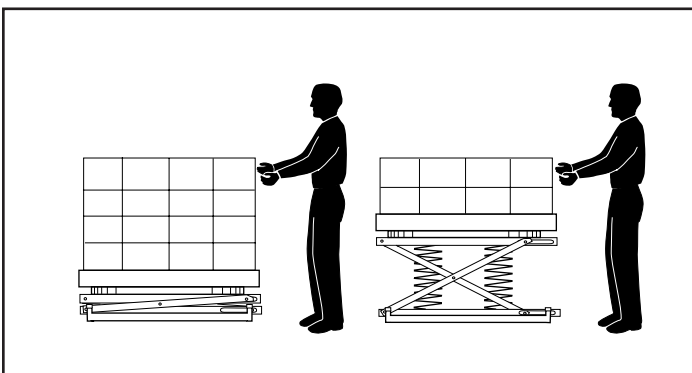

Fig. 20
Unloading Manually

Operating Safety - Manual Use

1. Do not use this unit with a load greater than the rated load. This includes the weight of the payload and the weight of the pallet. Table 1 on page 10 shows how to be sure you have the correct spring combination for your application.
2. Never push the load off of the side of the unit. If you do this, the frame of the unit may jump upward.
3. Never use the unit when anyone is sitting or riding on the rotating ring.
4. Do not try to use this unit with damaged or broken pallets. Broken pallets may have boards or nails which hang down below the main part of the pallet. As the pallet is turned, these boards or nails may catch on the frame. The pallet may stop turning suddenly and this can cause the load to shift. You may be injured and the unit may be damaged. If the boards or nails on the bottom of the pallet extend down more than $\frac{1}{8}$ inch, they will interfere with the turning action.
5. Stay clear of the rotating ring when it is moving. As the pallet turns, a part of the load may rotate around and hit you.
6. Keep the area around the unit clean. Do not allow any dirt, debris, spilled oil, or excess grease to collect. These materials may cause you to slip while the unit is operating and you may be injured.

Loading with a Fork Lift

1. Place the load on the lift, then lower the fork lift. Before removing the load, be sure the unit is carrying the weight, not the fork lift. See Fig. 21.
 - Lower the load until the springs on the PalletPal are fully compressed.
 - Be sure the forks on the lift are clear of the inside of the pallet.



If you skip these steps, the load may drop suddenly when you remove the fork lift. You may be hurt or the unit or load may be damaged.



Never drop the load on the rotating ring. If you do this while the rotating ring is moving, the load may shift. You may be injured or the unit may be damaged. If you drop the load while the rotating ring is stopped, the unit may be damaged.

2. Be sure the load is centered on the unit.



If the load is off-center, it may shift when the rotating ring is turned. You may be hurt or the unit or load may be damaged.

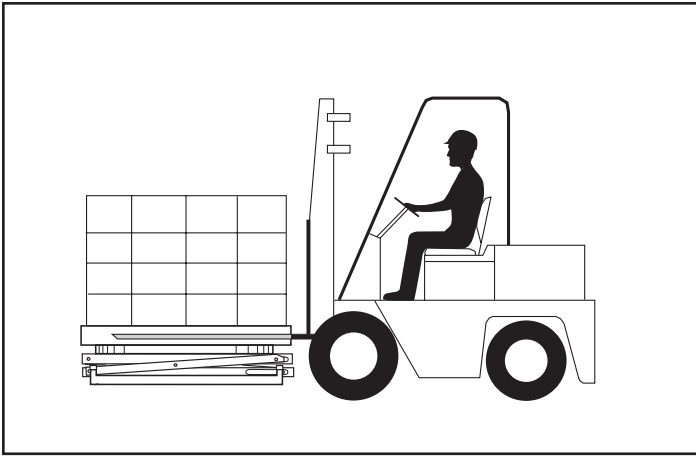

Fig. 21
Loading with a Fork Lift

Unloading with a Fork Lift

1. Insert the forks fully into the pallet, and lift the pallet straight up and clear of the top of the unit. See Fig. 22.

- Raise the pallet until the springs on the PalletPal are fully extended.
- Be sure the pallet clears the top of the rotating ring before you move the fork lift.

⚠ WARNING

If you skip these steps, the unit may jump up suddenly when you remove the pallet. You may be hurt or the unit or load may be damaged.

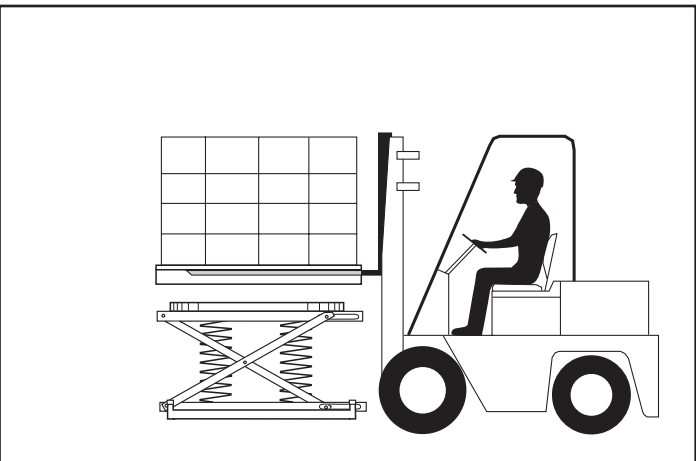

Fig. 22
Unloading with a Fork Lift

Moving the Pallet Pal

NOTICE

Do not move the Pallet Pal while it is loaded. This will damage the base frame of the unit. The pockets on the base frame are designed to support an unloaded PalletPal, but cannot support any extra weight.

1. Remove any load from the top of the Pallet Pal.
2. Insert the forks into the pockets in the base frame. See Fig. 23.

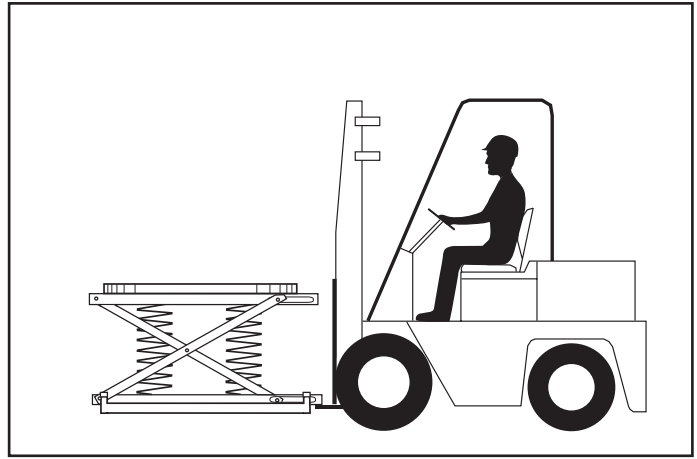

Fig. 23
Moving the Pallet Pal

Maintenance

Routine Periodic Maintenance

Every 90 days -

- Check for loose hardware and signs of excessive wear. On the models where the shock absorber is used, check for signs of leakage.
- Check to be sure that the unit is placed on a firm level surface. If the optional feet are installed, be sure that all four feet are touching the floor and are locked in position.

Shock absorber pivot pin to be used to chock lift as needed, ensure no load on unit see page 13, paragraph 5, figure 8.

Troubleshooting

Troubleshooting Check List

Problem	Possible Cause	Check This
The unit lowers too easily (too early).	The spring combination may be too weak for the load.	Check the spring ratings. See Table 1 on page 10.
The unit does not lower enough (too late).	The spring combination may be too strong for the load.	Check the spring ratings. See Table 1 on page 10.
The top of the unit rotates away from you.	The frame of the unit may not be level.	Move the unit to a level surface or install the optional adjusting feet.
The top of the unit bounces.	The shock absorber may be damaged.	Check for leaks or dents. Replace if damaged.
Excessive “rumble” when the ring rotates	Wear or lack of lubrication to bearings under rotating ring.	Remove turntable, lubricate or replace bearings.
Wear or metal flaking from underside of rotating ring.	Normal condition caused by work-hardening of metal.	No repair necessary. This will stop once the rotator ring wears in.

Ordering Replacement Parts

Southworth has carefully chosen the components in your unit to be the best available for the purpose. Replacement parts should be identical to the original equipment. Southworth will not be responsible for equipment failures resulting from the use of incorrect replacement parts or from unauthorized modifications to the unit.

Southworth can supply all replacement parts for your PalletPal. With your order, please include the model number and the serial number of the unit. You can find these numbers on the name plate. This plate is located within the scissors mechanism.

To order replacement parts, please call the Parts Department at (207) 878-0700, (800) 743-1000, or email repairparts@southworthproducts.com. Parts are shipped subject to the following terms:

- FOB factory
- Returns only with the approval of our Parts Department.
- Payment net 30 days (except parts covered by warranty).
- Freight collect (except parts covered by warranty).
- The warranty for repair parts is 30 days from date of shipment.

Parts replaced under warranty are on a “charge-credit” basis. We will invoice you when we ship the replacement part, then credit you when you return the worn or damaged part, and we verify that it is covered by our warranty. Labor is not covered under our warranty for Parts orders.

Parts Department
Southworth Products Corp.
P.O. Box 1380
Portland, Maine, 04104-1380
Telephone: (800)743-1000 or (207)878-0700
FAX: (207)797-4734
Service@SouthworthProducts.com

WARRANTY

Southworth Products Corp warrants this product to be free from defects in material or workmanship for the life of the product providing claim is made in writing. This warranty shall not cover modified designs for special applications, failure or defective operation caused by misuse, misapplication, negligence or accident, exceeding recommended capacities, failure to perform required maintenance or altering or repairing, unless alteration is authorized by Southworth Products Corp. Except as set forth herein, there are no other warranties, express or implied, including the warranties of merchantability and fitness for a particular purpose, all of which are hereby excluded.

Southworth Products Corp makes no warranty or representation with respect to the compliance of any product with state or local safety or product standard codes, and any failure to comply with such codes shall not be considered a defect of material or workmanship under this warranty. Southworth Products Corp shall not be liable for any direct or consequential damages arising out of such noncompliance.

Southworth Products Corp's obligation under this warranty is limited to the replacement or repair of defective components at its factory or another location at Southworth Products Corp's discretion. The Southworth Warranty is for product sold with in North America. For products shipped outside of North America the warranty will be for replacement of defective parts only. Labor is not included. This is buyer's sole remedy. Except as stated herein, Southworth Products Corp will not be liable for any loss, injury or damage to persons or property, nor for direct, indirect, or consequential damage of any kind, resulting from failure or defective operation of said product.

This warranty may be altered only in writing by Southworth Products Corp, Portland, Maine.

SOUTHWORTH

SOUTHWORTH PRODUCTS CORP
P.O. Box 1380, Portland, ME 04104-1380
Telephone: (800) 743-1000 • (207) 878-0700
Fax: (207) 797-4734
www.SouthworthProducts.com