



SOLUTIONS FOR STORAGE

ROLL-FORMED
**PALLET
RACK**

TRI-BORO PALLET RACK FEATURES & BENEFITS



Obtain warehouse racking and shelving products on one order from one source - Tri-Boro Storage Products. We manufacture our own pallet rack to the same standards of quality and performance you've come to expect from our other storage products. Tri-Boro now offers the added value and logistical advantage of single source integration for all your warehousing and storage needs.

- One Source for Industrial Steel Shelving and Warehouse Rack
- Quick Ship Program
- 100% USA Made

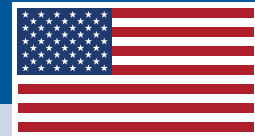

Single Rib Column Design: Adds to strength and rigidity.

Tapered Keyhole Slots: Pulls beam against frame for maximum stability.

Return bends on all open-back design frame members: No sharp exposed edges - Adds to strength and rigidity.

Interchangeable product design: TRI-BORO rack is compatible with most "teardrop" design pallet racks.

One-piece tube seamed step beams: No exposed welds, which can cause pallet hang-ups. Safer for retail applications.

High strength tapered studs on beam connector plates: Extra safe connection and snug fit. Less stress on components than slot and hook connections.

Integral beam connector safety locks: Self-engaging design is secure, easy to use and allows for quick repositioning of beams. Factory installed - replaceable.

Quick & Easy Assembly: Saves time and money. No loose hardware.



Powder coat baked finish: Durable, scratch resistant high gloss finish. Ideal for many food and industrial corrosive applications.

Full range of capacities and sizes from hand-loaded bulk rack to your heaviest applications: One source for all your storage needs. Complete turn-key services available through a qualified network of full line material handling distributors.

Stock rack for immediate requirements: Warehouses and stocking dealers around the country with a large selection of popular size racks.

Factory Support: Large enough to handle any size job. Small enough for the personal services that most companies cannot provide.

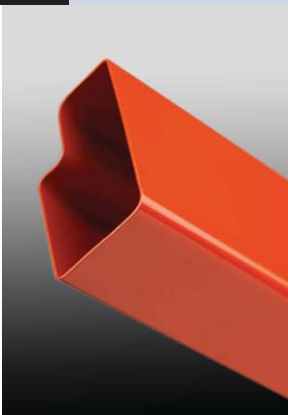

Tri-Boro Storage Products | 800-633-3070 | www.TriboroShelving.com



FRAME CAPACITIES (LBS.)

MAXIMUM VERTICAL BEAM SPACING	F14* 14g. 3" x 1 5/8" COL.	F20 14g. 3" x 2 1/2" COL.	F24 13g. 3" x 2 1/2" COL.	F25 14g. 3" x 3" COL.	F30 13g. 3" x 3" COL.	F35 12g. 3" x 3" COL.
36"	17437	23906	28005	27798	31162	38909
42"	16400	22610	26364	26020	29481	36692
48"	15220	21149	24530	23200	27594	34218
54"	13937	19559	22557	21040	25549	31556
60"	12594	17884	20502	19163	23398	28775
66"	11232	16167	18420	17145	21194	25948
72"	9870	14426	16332	15147	18965	23101
78"	8683	12794	14406	13030	16842	20448
84"	7679	11396	12771	11916	15019	18183
90"	6827	10195	11379	10529	13449	16243
96"	6101	9160	10188	9533	12095	14577

- Notes:
- Based on RMI 2019 Specification for the Design, Testing and Utilization of Industrial Steel Storage Racks.
 - "Spacing" is distance from floor to top of first beam level. If maximum opening is not floor level, "Spacing" is distance from top of beam to top of beam + 1".
 - Applicable for non-seismic use only. Building codes may require otherwise.
 - Capacities are for frame components only. Overall rack system configuration is the responsibility of others.
 - Contact your Tri-Boro representative for design assistance or for applications not covered by above.
 - Where the bottom portion of frames are exposed to potential minor impacts from forklift trucks or moving equipment, consideration should be given to purchasing one of the optional impact protection devices. Ask your Tri-Boro representative for a recommendation.
 - *F14 Frame capacity: 4,000 lbs. max per beam level.

SPECIAL ORDER ITEMS - MINIMUM RUN REQUIREMENTS APPLY. Please contact your Tri-Boro representative for more information.

SPECIFICATIONS

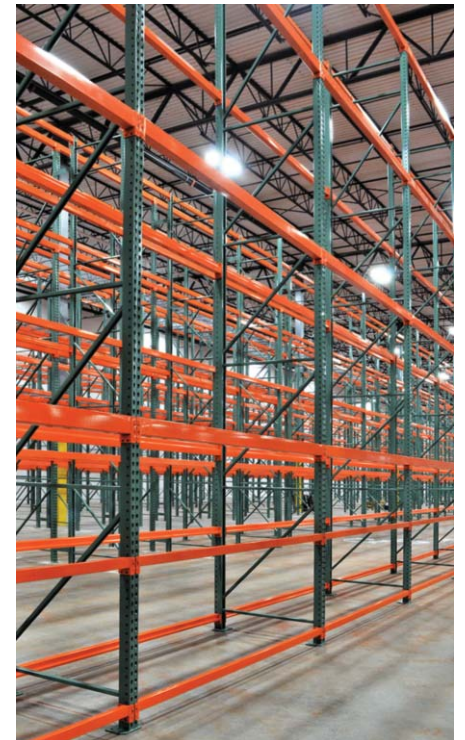

ROLL-FORMED FRAME PART NUMBER

(EXAMPLE: 3" x 2 1/2" x 42" x 192")

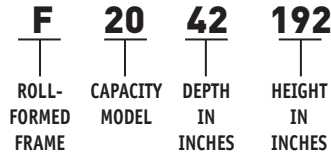

ROLL-FORMED STEP BEAM PART NUMBER

(EXAMPLE: 4 1/8" x 96")

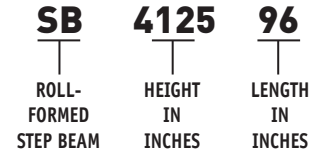

ROLL-FORMED STEP BEAM CAPACITIES (LBS. PER PAIR)

BEAM LENGTH (INCHES)	BEAM PROFILE MODEL NO.	BEAM PROFILE						
		SB2500 4" CONNECTOR (2 STUD)	SB3500 6" CONNECTOR (3 STUD)	SB4125 6" CONNECTOR (3 STUD)	SB4625 6" CONNECTOR (3 STUD)	SB5125 6" CONNECTOR (3 STUD)	SB6000 6" CONNECTOR (3 STUD)	SB6500 8" CONNECTOR (4 STUD)
48"		3836	6910	8775	10597	12000	12000	12000
72"		2532	4743	5975	7186	9029	12000	12000
84"		2022	4485	5734	6883	8632	12000	12000
96"		1505	3483	5028	6067	7596	10583	12000
102"		1310	3106	4476	5731	7168	9975	11825
108"		1146	2788	4011	5309	6788	9434	11206
120"		885	2283	3276	4330	5887	8512	10152
144"				2303	3038	4120	6511	8482

- Notes:
- Based on RMI 2019 Specification for the Design, Testing and Utilization of Industrial Steel Storage Racks.
 - Load Capacities are based on uniformly distributed product load per pair of beams.
 - Deflection is based on product load only, and is limited to L(span)/180.
 - Spans from 48" to 80" designed for 25% impact from placing 1 load per shelf.
 - Spans from 82" to 120" designed for 25% impact from placing 1 of 2 loads per shelf.
 - Spans from 122" to 144" designed for 25% impact from placing 1 of 3 loads per shelf.
 - Applicable for non-seismic use only. Building codes may require otherwise.
 - Capacities are for beam components only. Overall rack system configuration is the responsibility of others.
 - Contact your Tri-Boro representative for design assistance or for applications not covered by above.



Tri-Boro Storage Products
800-633-3070
www.TriboroShelving.com

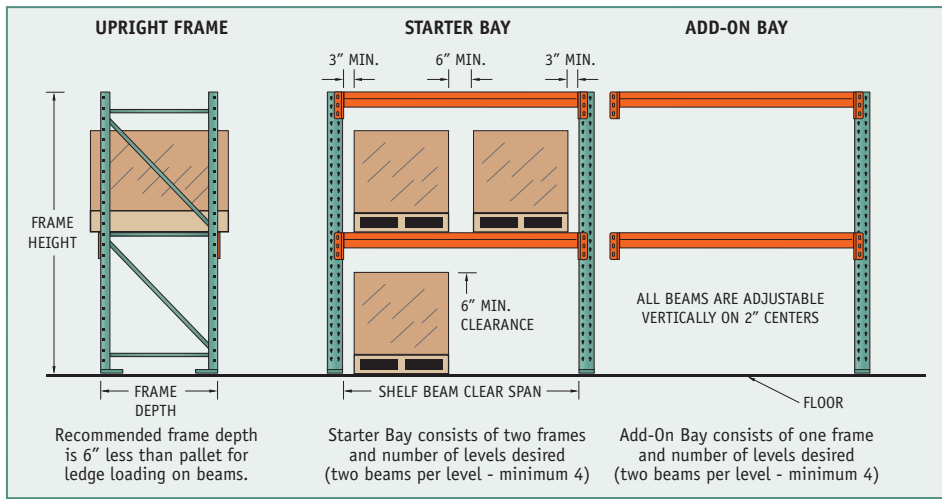

HOW TO ORDER

BEAM LENGTH: SHELF LENGTH EQUALS THE DISTANCE BETWEEN UPRIGHTS. IT IS DETERMINED BY ADDING THE WIDTHS OF PALLET LOADS PLUS A 3" SIDE CLEARANCE BETWEEN UPRIGHT AND PALLET AND 6" BETWEEN PALLET LOADS. SHELF BEAM CAPACITIES ARE BASED ON A PAIR OF BEAMS SUPPORTING AN EVENLY DISTRIBUTED LOAD.

RACK HEIGHT: ADD THE FOLLOWING FIGURES:

- HEIGHT OF PALLET LOADS (INCLUDING PALLET)
- + HEIGHT OF SHELF BEAM
- + 6" MINIMUM VERTICAL CLEARANCE FOR EACH PALLET LOAD

SUM OF ABOVE DIMENSIONS = RACK HEIGHT

FOR UPPERMOST LOAD LEVEL, LOCATION OF SHELF BEAM SHOULD BE 6" LESS THAN FORK TRUCK'S MAXIMUM LIFT HEIGHT. TOP OF BEAMS NEED TO BE AT 2" INCREMENTS.

TRI-BORO PALLET RACK ACCESSORIES

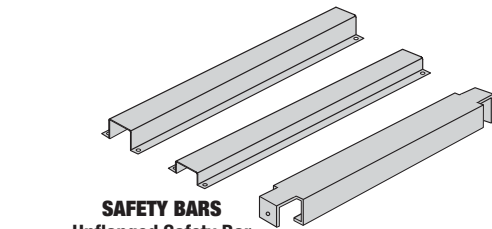

SAFETY BARS
Unflanged Safety Bar
USB(length in inches) example: USB24
Low Profile: USB42LP
Flanged Safety Bar
FSB(length in inches) example: FSB42

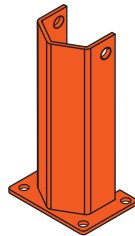

COLUMN PROTECTOR
PART NO.: CP18



BOLT-ON COLUMN PROTECTOR
CPB(height in inches)
example: CPB018

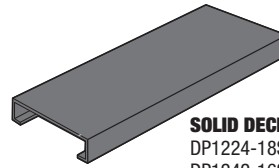

SOLID DECK
DP1224-18S
DP1242-16S

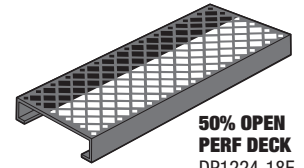

50% OPEN PERF DECK
DP1224-18F
DP1242-16F

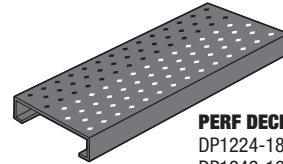

PERF DECK
DP1224-18P
DP1242-16P

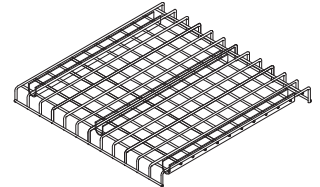

WIRE DECK
WD(length/width in inches)
example: WD4246 (for pallet rack)

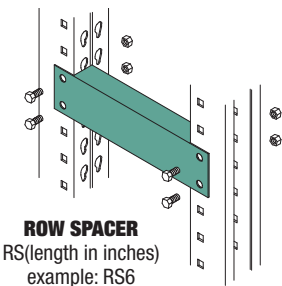

ROW SPACER
RS(length in inches)
example: RS6

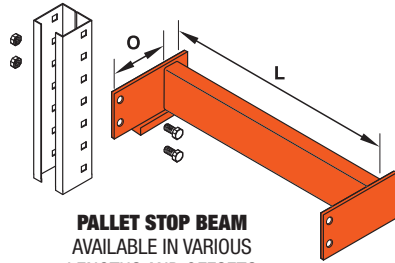

PALLET STOP BEAM
AVAILABLE IN VARIOUS LENGTHS AND OFFSETS

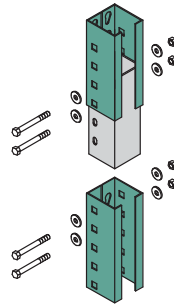

FRAME SPLICE
SPLF14
SPLF20
SPLF25
Hardware:
HD383.5X

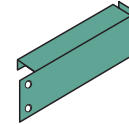

WALL SPACER
WS(length in inches)
example: WS6

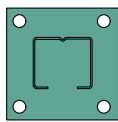

6 x 6 x 1/4" FOOTPLATE

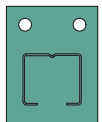

5 x 8 x 3/8" FOOTPLATE

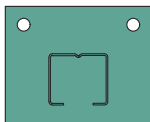

8 x 8 x 3/8" FOOTPLATE

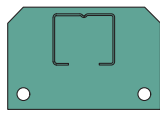

SEISMIC FOOTPLATE
PART NO.: FP57

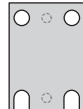

SHIM
PART NO.: SHM



WEDGE TYPE ANCHOR BOLT
PART NO.: WAB

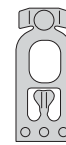

SAFETY LOCK
PART NO.: SNPLK

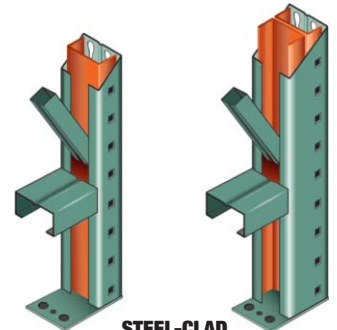

STEEL-CLAD
INTERNAL IMPACT PANELS - AVAILABLE FOR ALL TRI-BORO PALLET RACK FRAME MODELS. INCLUDES HEAVY DUTY BOTTOM HORIZONTAL. NOT FIELD RETROFITTABLE. SPECIAL ORDER ONLY.

STANDARD COLORS



VISTA GREEN

SIGNAL ORANGE

AVAILABLE COLORS

Additional charges apply and lead time may be affected.



*SPECIAL ORDER COLOR - MINIMUM RUN REQUIREMENTS APPLY. Please contact your Tri-Boro representative for more information.

SHELVING • SERVICE CARTS • PALLET RACK • WORK BENCHES • SHOP DESKS • SPECIALTY RACKS

Tri-Boro Storage Products

www.TriboroShelving.com

300 Dominion Drive | Farmville, VA 23901 | 800-633-3070 | fax 434-315-0139

19-40 Flushing Ave. | Ridgewood, NY 11385 | 718-782-8527 | fax 718-963-0457

